

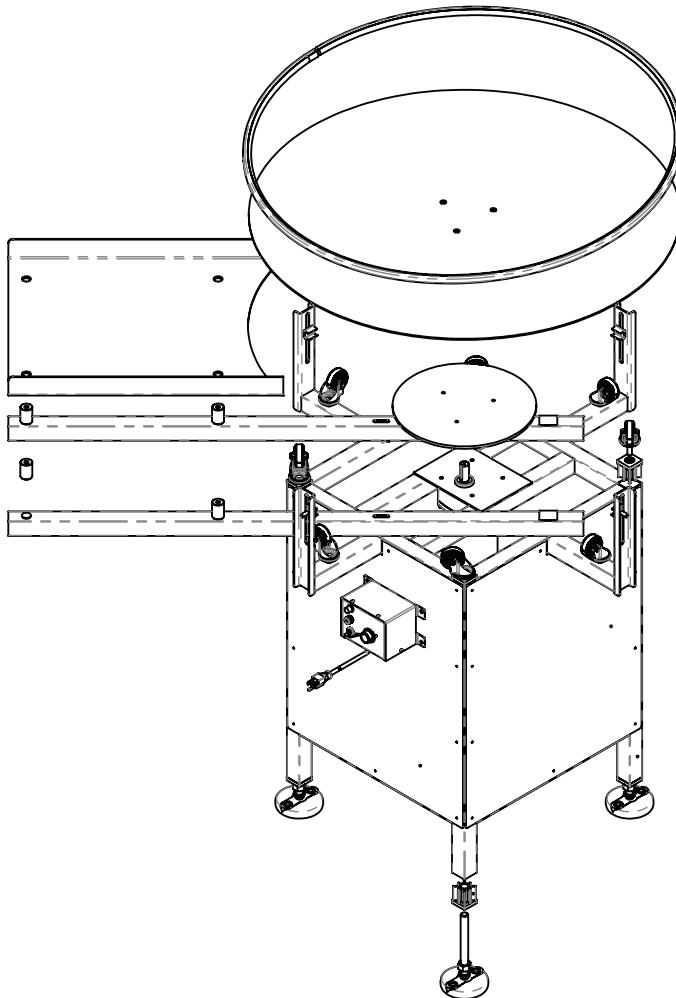

## OPERATIONAL MANUAL - ROTARY TABLES



ROT-24OAN	ROT-24EAN
ROT-24OAY	ROT-24EAY
ROT-24OUN	ROT-24EUN
ROT-24OUY	ROT-24EUY
ROT-36OAN	ROT-36EAN
ROT-36OAY	ROT-36EAY
ROT-36OUN	ROT-36EUN
ROT-36OUY	ROT-36EUY
ROT-48OAN	ROT-48EAN
ROT-48OAY	ROT-48EAY
ROT-48OUN	ROT-48EUN
ROT-48OUY	ROT-48EUY
ROT-60OAN	ROT-60EAN
ROT-60OAY	ROT-60EAY
ROT-60OUN	ROT-60EUN
ROT-60OUY	ROT-60EUY



SAFETY



SPECIFICATIONS



SETUP



MAINTENANCE



PARTS

This manual is designed to assist in making the installation, setup, operation and troubleshooting of your equipment as easy and informative as possible. We ask that you carefully review the procedures covered in this manual prior to contacting the technical staff here at Globaltek. We are here to assist you in resolving any issues you may have, do not hesitate to contact us.

We can be reached  
Mon. – Fri., 9:00 AM – 5:00 PM  
Telephone: (305) 418-9632 Fax:(305)704-8099  
[sales@globaltekconveyors.com](mailto:sales@globaltekconveyors.com)  
[logistics@globaltekconveyors.com](mailto:logistics@globaltekconveyors.com)

---

“We appreciate your business and we are pleased that you have chosen Globaltek for your packaging needs”.



## SAFETY

To ensure the safety of qualified personnel it is imperative that they understand the dangers, warnings and caution notices. Therefore, it is important to understand the signal words, which will be seen throughout this manual. The safety of equipment and plant facilities should be considered during equipment operation, change of product, and any approved equipment modification.

Before attempting to perform any operation, maintenance or inspection of this equipment, it is imperative that all safety precautions and warnings herein be adhered to. If you have any questions or concerns regarding the information in this manual, do not hesitate to contact us.

Signal words and symbols that you should become familiar with before continuing:

### **Lock Out – Tag Out Standard Procedures**

It is standard procedure that any individual engaging in the maintenance, repair, cleaning, servicing, or adjusting of machinery or equipment, will follow the procedures outlined in this document. These procedures are designed to meet or exceed applicable OSHA standards and SORM guidelines for safe work practices. The primary purpose is to help ensure that all individuals within the facility are protected from injury or death resulting from the accidental or unexpected activation of equipment during maintenance, repairing, cleaning, servicing, or adjustments. Definitions:

**Lock out** - The practice of using keyed or combination security devices ("locks") to prevent the unwanted activation of mechanical or electrical equipment.

**Tag out** - The practice of using tags in conjunction with locks to increase the visibility and awareness that equipment is not to be energized or activated until such devices are removed. Tags will be non-reusable, attachable by hand, self locking, and not easily removed.

The Safety of personnel, equipment, and plant facilities should be considered with each change of product, and any approved machinery modifications.





## SAFETY



---

### **Read and understand Operation and Safety Manual before operating this machine.**

- **Do NOT** move without additional personnel or mechanical assistance.
- **Never** operate this machine without all safety guards and covers in their proper positions.
- Refer servicing to qualified original manufacturer's service personnel.
- Disconnect and lockout all power and air sources prior to any service or maintenance work.
- Keep hands and foreign objects away from all moving parts and pinch points.
- Always wear OSHA approved eye/ear protection when operating this machine.
- **Do not** make any changes or modifications to this machine.
- **Never** operate this machine with long hair, jewelry or loose clothing.
- This machine may start automatically or remotely at any time.
- **Never** stand or climb on machine or conveyor - use only an OSHA approved stepladder.
- Machine design including controls and logic should not be changed or modified since it may result in machinery damage or



## SPECIFICATIONS

### OVERVIEW

The Globaltek rotary tables can be used to unscramble product and feed a conveyor, also as a buffer space to accumulate product until the downstream conveyor is ready for additional product or collect. Accumulating rotary tables are designed to collect filled containers from a filling line to prevent slowdowns by quickly removing the finished product from the conveyors during operation. Can be set for clockwise and counterclockwise rotation. Accumulating rotary tables are designed to collect filled containers from a filling line to prevent slowdowns by quickly removing the finished product from the conveyors during operation. Can be set for clockwise and counterclockwise rotation.

### MAIN FEATURE

- MADE IN USA WITH 100% UL CERTIFIED COMPONENTS
- STAINLESS STEEL OPEN FRAME OR ENCLOSED CABINET
- ADJUSTABLE LEVELING PADS
- DISK THICKNESS 1/8" (11 GAGE)
- COUNTER AND CLOCKWISE
- BODINE DC DRIVE FOR ROTATION SPEED CONTROL

### TECHNICAL DATA

- BODINE DC MOTOR, 1/11 HP, 8 RPM, 500LB/IN
- MACHINE ELECTRICAL REQUIREMENTS 115 VOLTS / 1 PH / 60 HZ
- ROTARY TABLE STANDARD SIZE: 36", 48", 60" (OTHER SIZES UPON REQUEST)
- FLOOR TO DISK: 35" TO 39"
- ADJUSTABLE GUIDE RAIL HEIGHT: 0" TO 5"
- MAX WEIGHT CAPACITY 800LBS PER SQUARE FT
- SPEED: 0 TO 8 RPM

### OPTIONAL FUTURE

- TOOLESS BOTTLE ORIENTING GUIDES
- INFEED TABLE FOR HAND PACKING APPLICATIONS OR TO PUSH LOAD CONTAINERS ONTO ROTATION DISC
- LOCKING CASTERS
- DUAL GUIDE RAILS
- 4" STAINLESS STEEL GUIDE RAILS
- TRANSFER PLATE FOR SMOOTHER CONTAINER TRANSITION (SIDE OR STRAIGHT MOUNT)

### WARRANTY

- 12 MONTHS (LIMITED WARRANTY)



## SETUP

### **READ THIS GUIDE BEFORE BEGINNING THE INSTALLATION!**



It is the responsibility of the installer to follow the manufacturer's guidelines and requirements. Failure to observe these guidelines and requirements could compromise some or all warranty considerations on the part of Globaltek. Refer to any special component installation instructions that may be included with job documents for more details regarding special issues.

- 1 ◀ After uncrating and unpacking, examine all components of the system
- 2 ◀ Place unit where is needed. 110 VAC electricity will be required near the electrical box.
- 3 ◀ Level the machine, making sure all bases are firmly on the floor and unit does not teeter or rock.
- 4 ◀ Height adjustments are made with the adjustable bases on the table frame
- 5 ◀ Disc level adjustments are made by adjusting the support casters.
- 6 ◀ Guide rail adjustments are made by loosening the clips on the table brackets. Move up or down on the slope as needed. Once placement has been selected tighten clip to set.
- 7 ◀ Now it is time to connect your unit, please make sure to check the voltage requirements and that this part of the set up is done by the appropriate personel.
- 8 ◀ The unit is now ready to be put service.
- 9 ◀ Turn the switch to the On position and adjust to desired speed with the knob on the variable speed control.



## MAINTENANCE

### **For general cleaning :**

- Clean stainless steel surfaces with a soft cloth and a mild detergent intended for use with stainless steel.
- Flush with clean water or wipe down with a clean wet cloth, and then wipe dry to avoid streaking and spotting.
- Chlorinated detergents and sanitizing agents will damage stainless steel unless thoroughly flushed or wiped away.

---

### **Do not spray water onto the motor, speed control and electrical connections.**

---

- Keeping the table system clean is essential to proper operation and sanitation guidelines.
- During the work periods, keep the table relatively clean of accumulated debris.



## PARTS

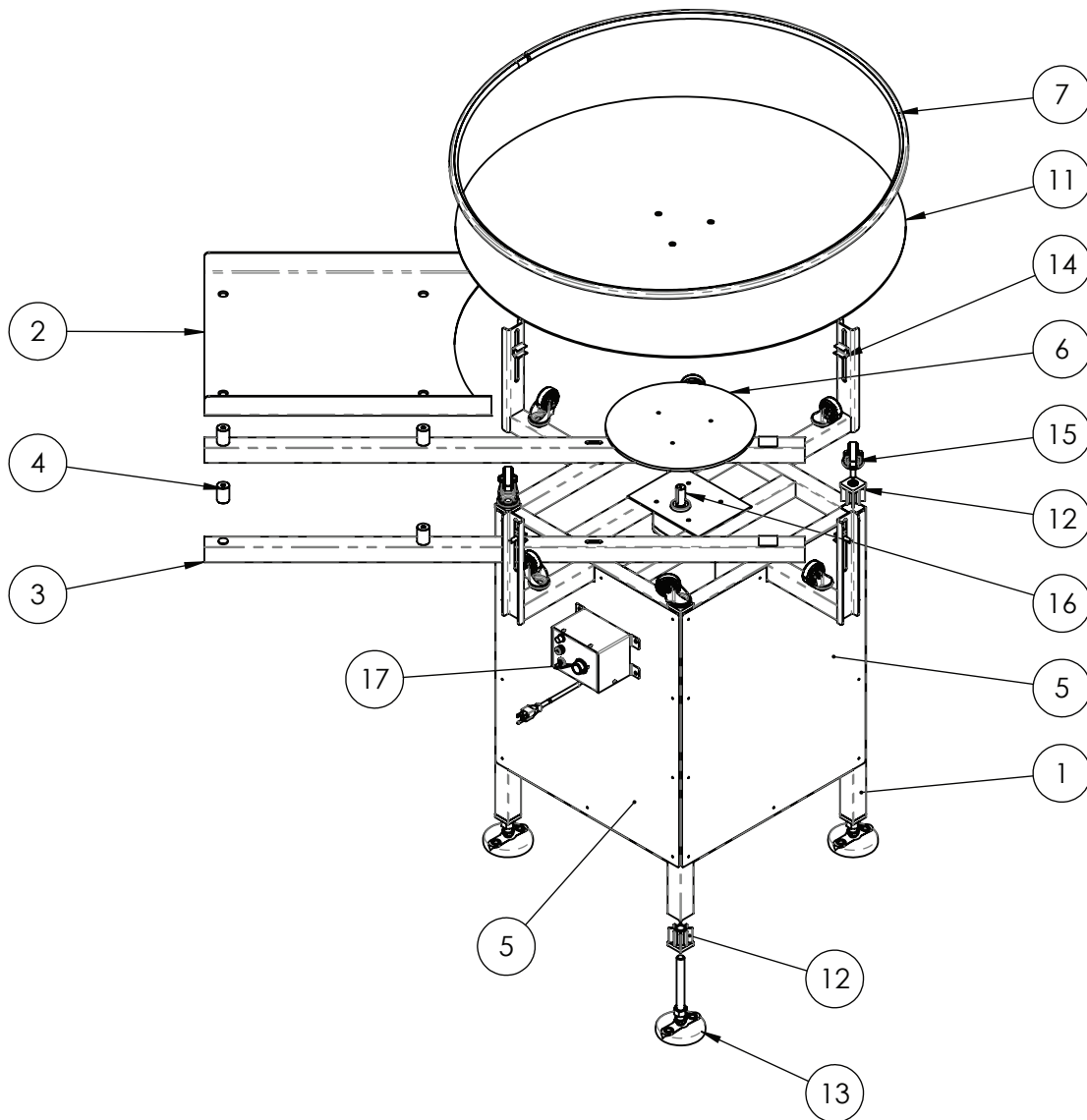





## PARTS

ASSEMBLY BILL OF MATERIALS			
ITEM	QTY.	PartNo	Description
1	1	RT-001-01-01	FRAME WELDMENT 36"
2	1	RT-001-01-06	INFEED TABLE 36"
3	2	RT-001-01-07	INFEED TUBING 36
4	4	RT-001-01-08	SPACER
5	4	RT-001-01-09	SKIRT 36"
6	1	RT-001-01-10	SHAFT
7	1	RT-001-01-11	ROUND GUIDE RAIL
8	2	RT-001-01-15	FLAP HOLDER
9	2	RT-001-01-16	LONG FLAP
10	1	RT-001-01-17	SHORT FLAP
11	1	GLOBAL-36	TABLE 36"
12	8	60945K230	THREADED TUBE INSERT 5/8-11
13	4	2531K680	SWIVEL LEG 5/8-11 WITH HOLES
14	4	VG-018-02.750	CLIP, RAIL MOUNTING
15	9	GS10	CASTER
16	1	5049	GEARMOTOR
17	1	0791	GEARMOTOR

### **ADD ON :**

#### **In feed Table:**

Stainless steel construction, with plastic table supports.

#### **Installation:**

You have to remove rotary table disc by removing the three center screws.

Line up in-feed table to the pre drilled holes on the rotary table frame

Secure in-feed with the provided hardware.

Place rotary table disc back on table with the three screws.